



a division of ADS Corporation

Baltimore SSO Site Investigation Report

FM Initials: DF

Project: 15 Maiden's Choice Interceptor

Site Name:	15_PRE	Monitor Series:	4000	Monitor S/N:	1184	Manhole #:	N/A	Investigation Information: Upstream Input: (L/S, P/S) N/A Upstream Manhole: N/A Downstream Manhole: N/A Depth of Flow: 14.25" Description of Site Hydraulics:
Address / Location:	810 Caton Ave	Map Page #:	12	Map Grid #:	S 9			
		Pipe Height:	30"	Pipe Width:	30"			
		IP Address:	166.143.101.11					
Access:	Walk (Commercial)	GPS Coords:	N DD.dddd		W DD.dddd			
			39 16.530		76 40.3001			
Date/Time of Investigation:		12/12/2003 10:00						

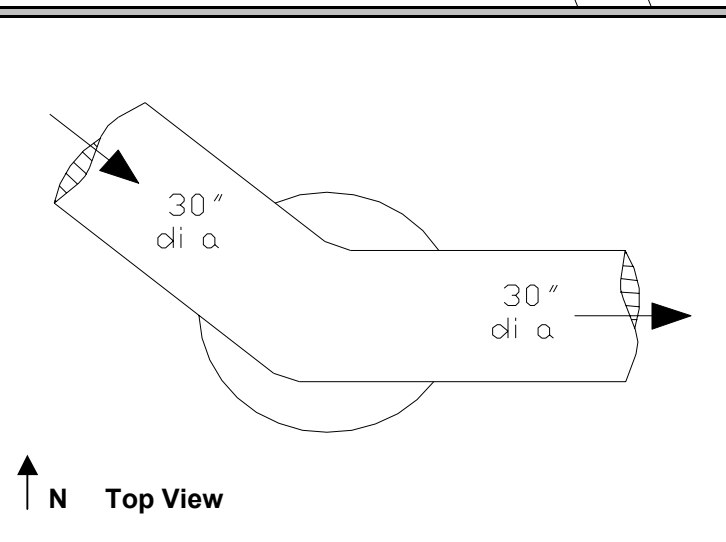
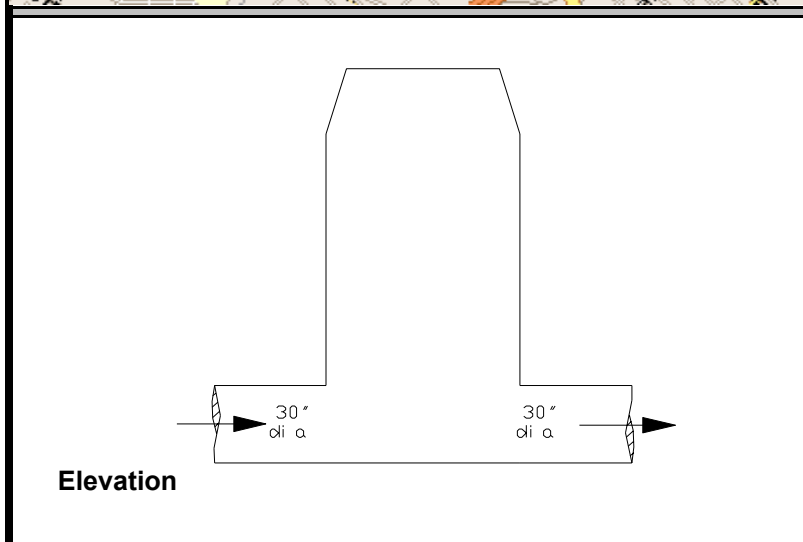
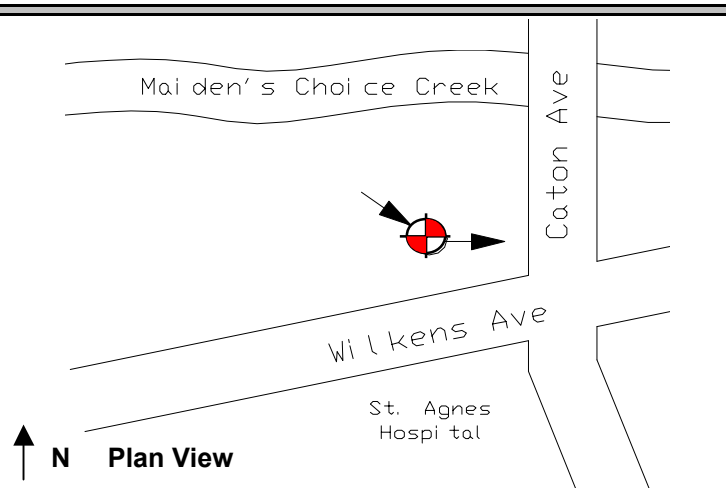
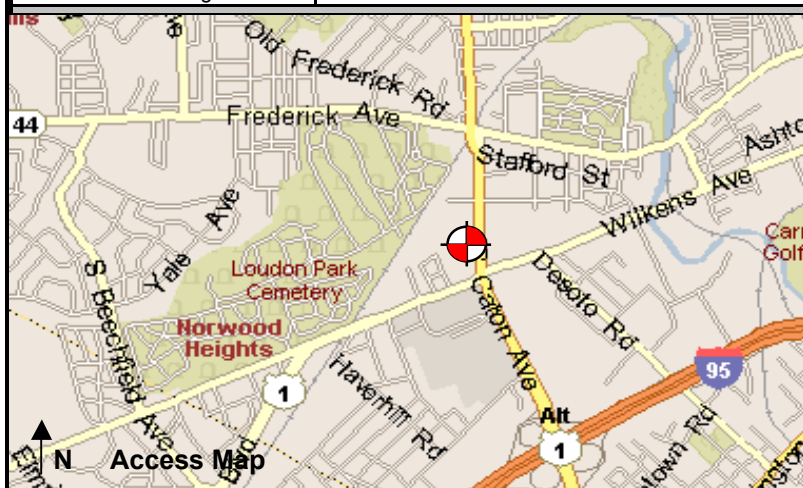

Manhole Information:
Manhole Depth: 8'
Manhole Material / Condition: Brick / Good
Active Drop Connections? None
System Character: Residential X Commercial Industrial

Notes:

Legend:
Cast Iron Flap Valve
Sensor Location
N.T.S.- Not to scale

The monitoring period ended as of March 31, 2005.